

REV.	ECN. NO.	NAME	DATA
AO	NEW	DING	2014-03-01

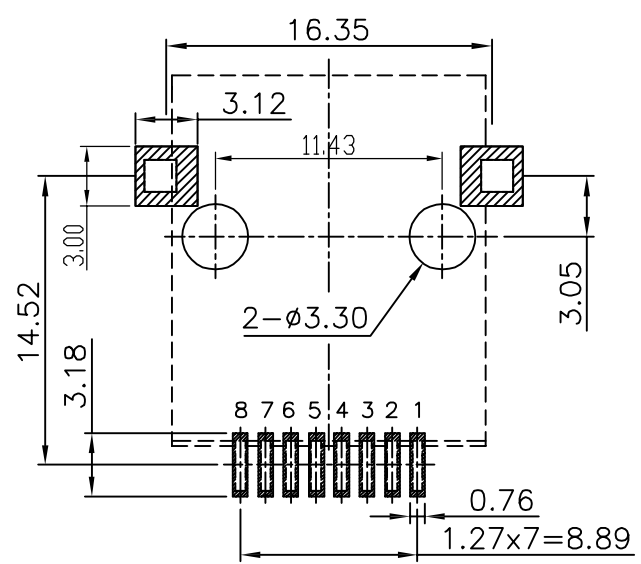
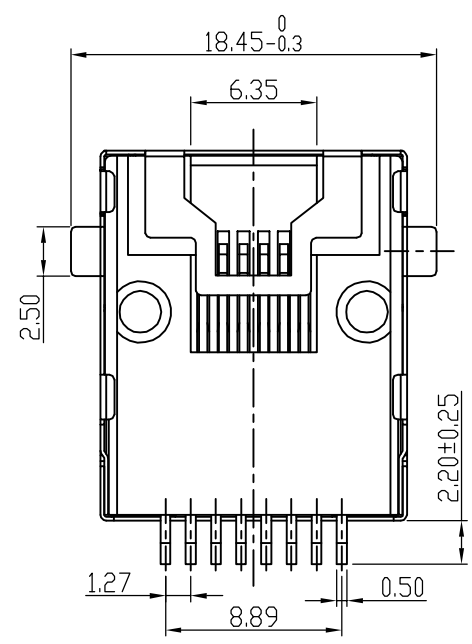
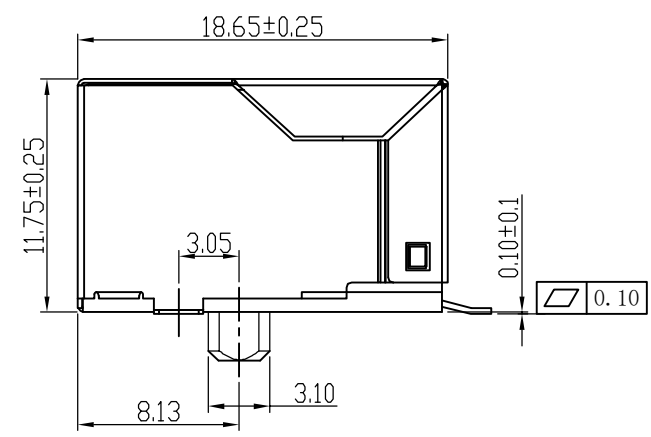
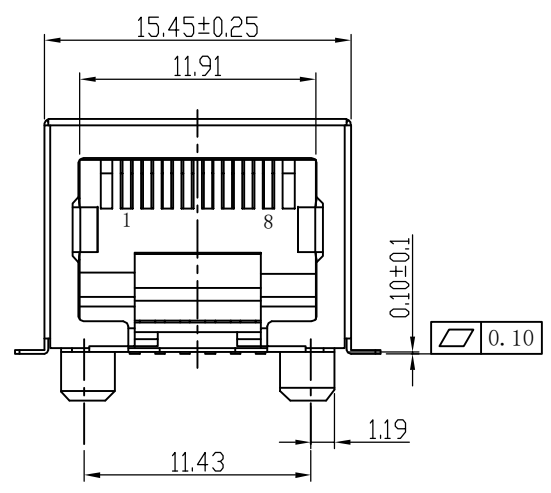

PCB LAYOUT/TOP VIEW

ELECTRICAL:

1. VOLTAGE RATING: 125 VAC RMS
2. CURRENT RATING: 1.5 AMP
3. CONTACT RESISTANCE: 20mΩ MAX.
4. INSULATION RESISTANCE: 1000MΩMIN. AT 500V DC.
5. DIELECTRIC STRENGTH: 1000 VAC 50Hz 1MINUTE

MECHANICAL:

1. HOUSING MATERIAL: THERMOPLASTIC, UL94V-0 RATED, COLOR BLACK.
2. CONTACT MATERIAL: PHOSPHOR BRONZE C5191-H T=0.30MM
3. PLATING: GOLD PLATING OVER NICKEL IN CONTACT. TIN PLATING OVER NICKEL IN SOLDER AREA.
4. SHIELD: T=0.20MM BRASS PLATING NICKEL ALLOY.
5. OPERATING LIFE: 750 CYCLES MIN.

ENVIRONMENTAL:

1. STORAGE: -40°C TO +85°C
2. OPERATION: -40°C TO +70°C

公差: TOLERANCES (INCH) MM .0 ± 0.20 .00 ± 0.15 .00 ± 0.075 角度 (ANGLES) ± 1.5° 第三角视图 第三角视图		绘图: DING2014/03-01 (Designed) 审核: (Checked) 批准: (Approved) 材料: SEE NOTES (Material) 比例: 1:1 (SCALE)
--	--	--

东莞市欣旺久电子有限公司	
系列 (SERIES)	名称 (NAME)
RJ	RJ45 18.1 SMT 全包 圆脚 FU" 脚高2.45
图号 (DWG NO.):	版本 REV. AO
料号 (PART NO.):	
单位 (UNIT): MM	共 (SHEET) 1 页 第 (OF) 1 页

1
2
3
4
5
6
7
8

A B C D E F G H